

50-55319KIT - Rear Folding Windshield
KAWASAKI RIDGE

SEIZMIK®

HIGHLIFTER

SEIZMIK™

FALCON RIDGE

 **SNORKEL**
YOUR ATV

SYSTEM 3
OFF-ROAD
Traction. Strength. Style.

EPI
PERFORMANCE

 service@seizmik.com

 **1-866-838-3366**
between 9:00 AM and 5:00 PM EST.



www.seizmik.com/customer-support

Parts Available For These Popular Brands and Others

POLARIS

can-am



HONDA

Kawasaki

 **YAMAHA**

PRODUCT INFORMATION

Seizmik®, the leader in manufacturing Windshields, Mirrors, Door Kits, Racks, and other great accessories for UTVs brings you the innovative, new Seizmik® Rear Fold-Down Windshield, to help you do what you do, better. This product does not require any modifications to your vehicle and fits the Kawasaki Ridge.

Familiarize yourself with all the steps before beginning assembly.

If you have any questions, comments, need assistance, or are missing parts, please visit our website <http://seizmik.com/customer-support> Or email us at service@seizmik.com. Visit www.seizmik.com for more information on our product or call 1-866-838-3366 between 9:00AM and 5:00PM EST.

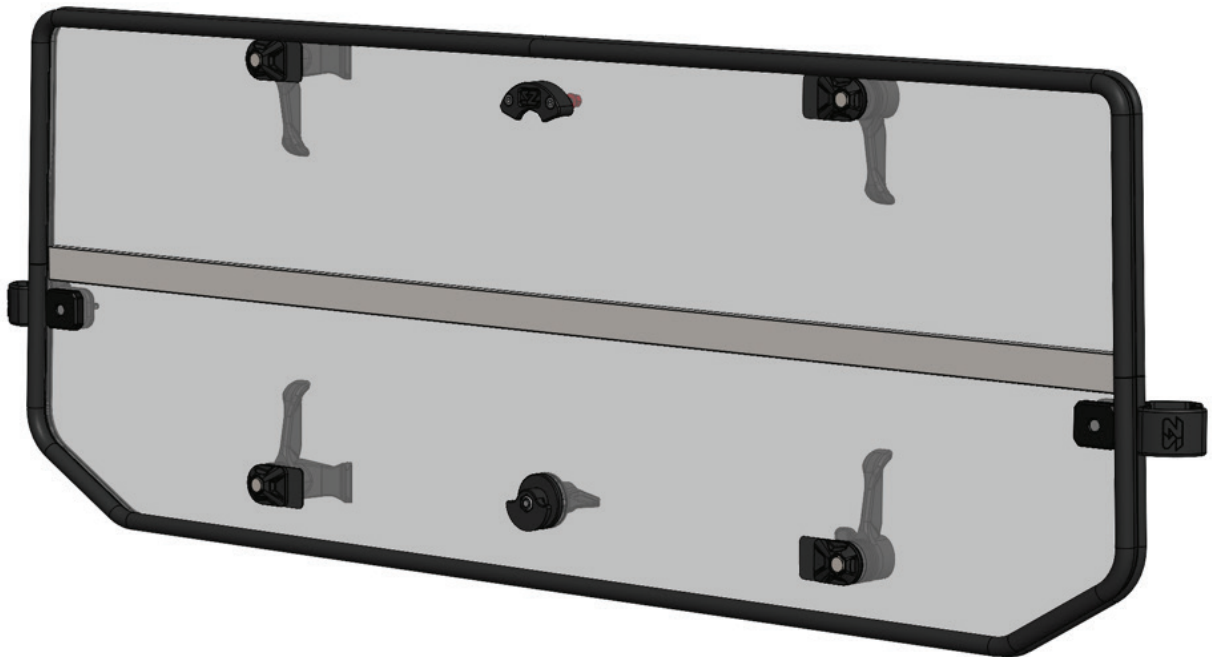

TOOLS NEEDED FOR INSTALLATION:

Item #	Item Description
1	Ratchet
2	10mm Deep Well Socket
3	13mm Deep Well Socket
4	3/16" Allen Wrench
5	Scissors/Utility Knife

INCLUDED INSIDE THE BOX:

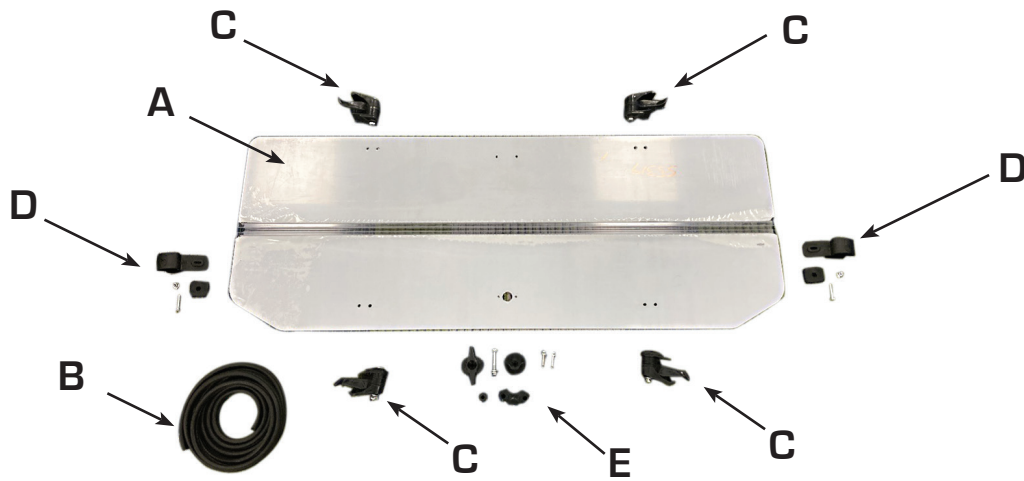

Item	Item Description	QTY
A	50-55319 - Windshield	1
B	54-90069-F - Gasket	1
C	54-90071 - Lever with Hardware	4
D	Pro-Fit Clamp with Hardware	2
E	Windshield Lock Assembly	1

ASSEMBLY INSTRUCTIONS FOR REAR FOLD-DOWN WINDSHIELD

STEP 1: Peel back the plastic protective film on both sides of the windshield to make it easier to install the gasket.

- Apply the Gasket (Item B) around the entire Windshield (Item A) starting at the hinge. Make sure the bulb on the gasket is facing opposite of the direction the windshield folds.
- If there is excess Gasket, cut the gasket using sharp scissor or a utility knife so that both ends are flush with each other.



STEP 2: Peel back more of the protective film on both sides to expose the slots for all 4 of the Levers (Item C).

- Use a 13 mm Deep Well Socket to disassemble the Levers.
- Remove all but 3 circular spacers.
- Assemble to the windshield panel between the spacer and the rubber pad opposite of the way the windshield panel folds.

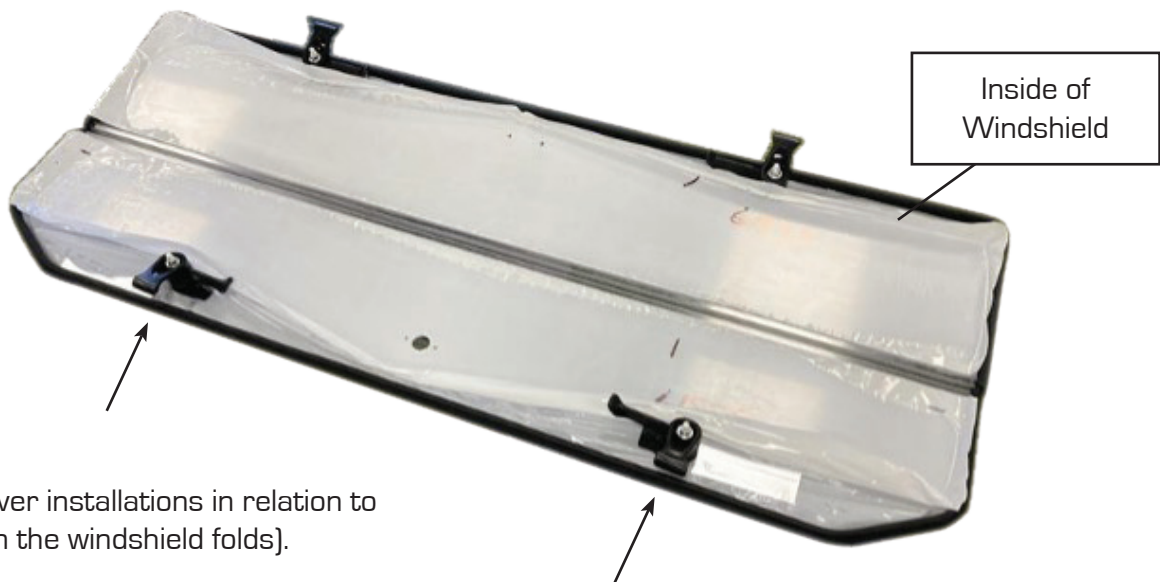
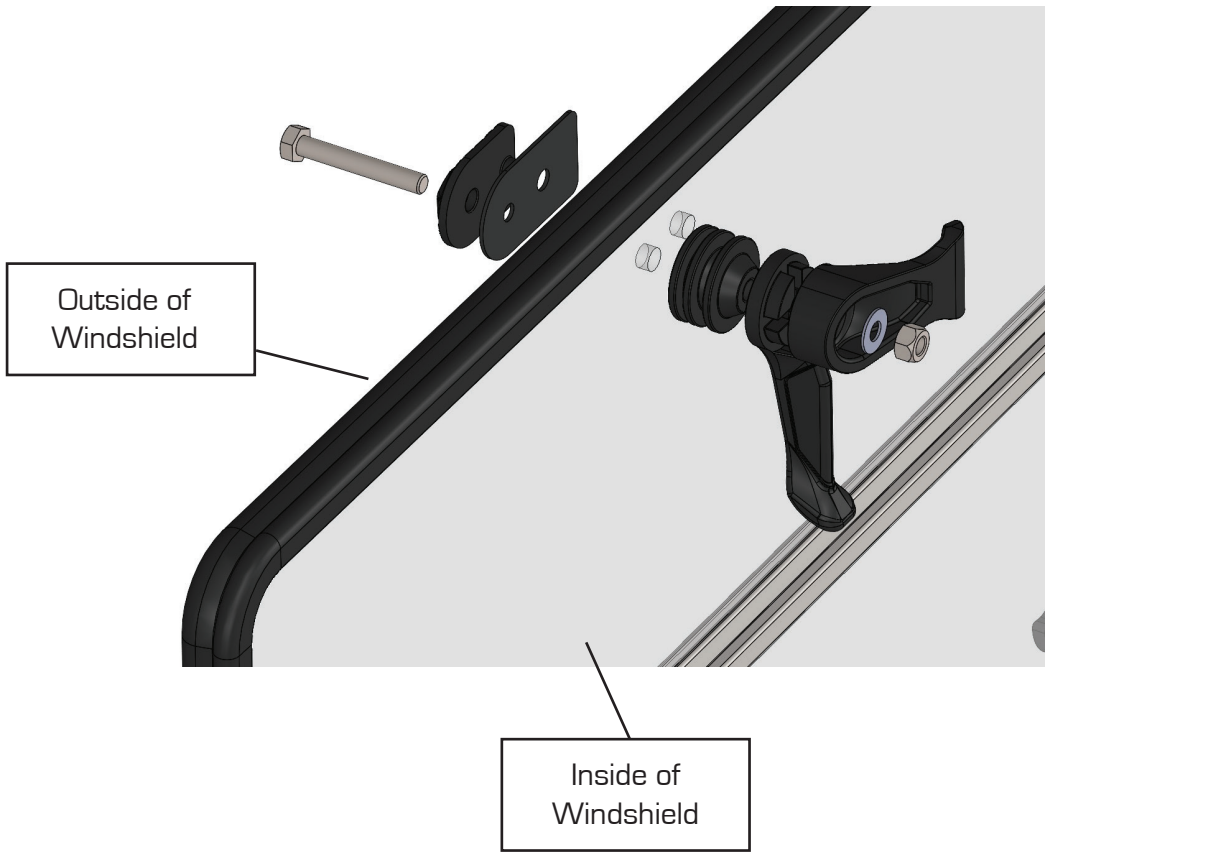

[Note the lever installations in relation to the direction the windshield folds].

STEP 3: Separate and organize the locking mechanism pieces into two sets, set 1 and set 2.



Hardware Set 1



Hardware Set 2

- Peel back the protective film on both sides to expose the round hole for the locking mechanism (Item E).



- Install hardware set 1 with the 13 mm Deep Well Socket. Be aware that the number of small parts makes this step a bit tricky. Don't lose the ball bearing or the spring! The ball bearing will sit in smaller hole cut out in the windshield.

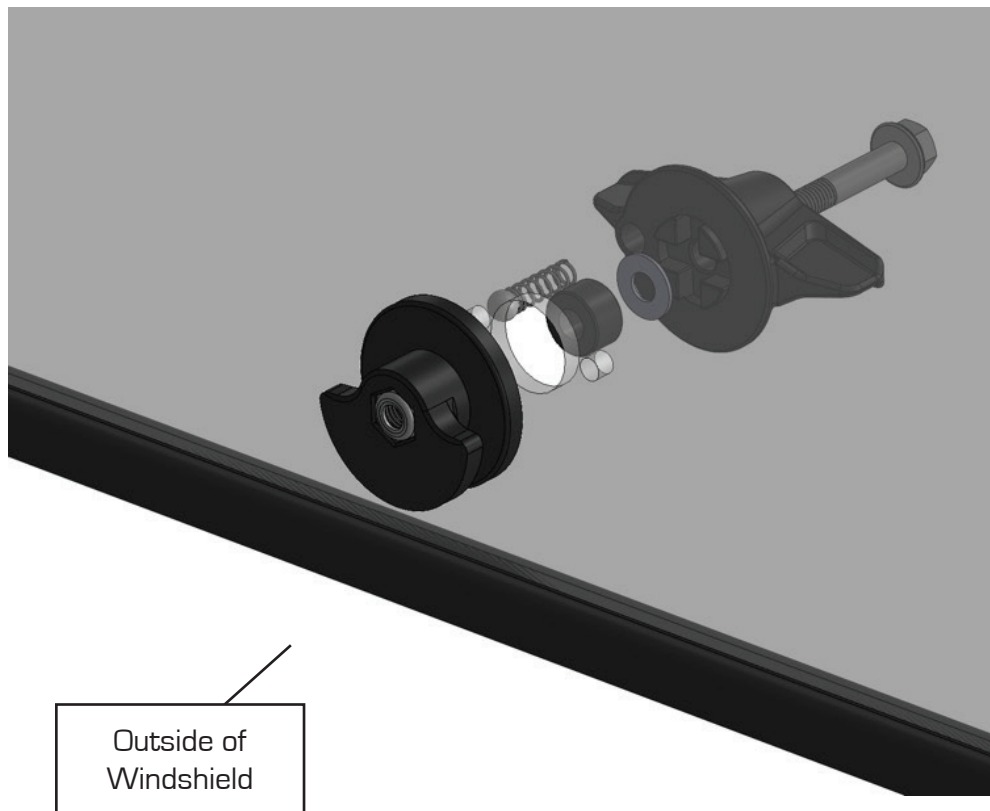
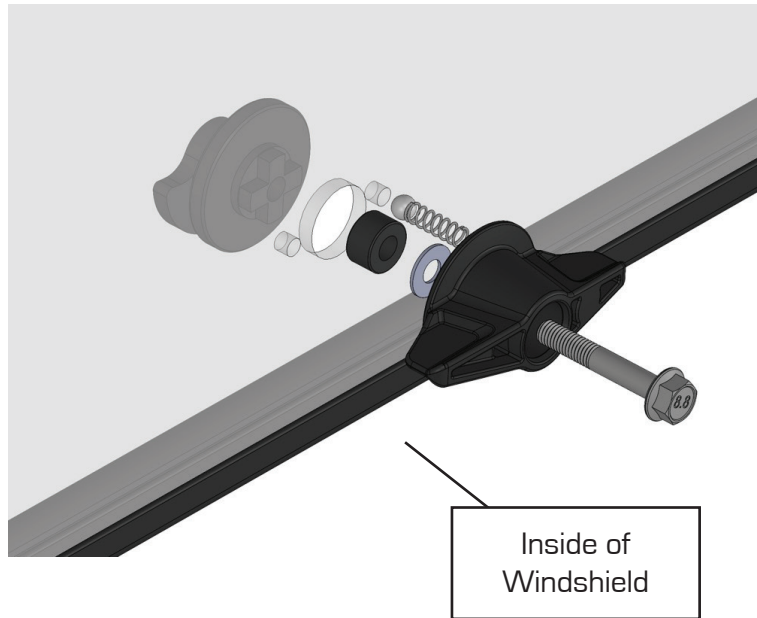

STEP 4: Install hardware set 2 with the 10mm deep well socket and the 3/16" allen wrench on the outside of the windshield. The outside is the opposite side of the levers.

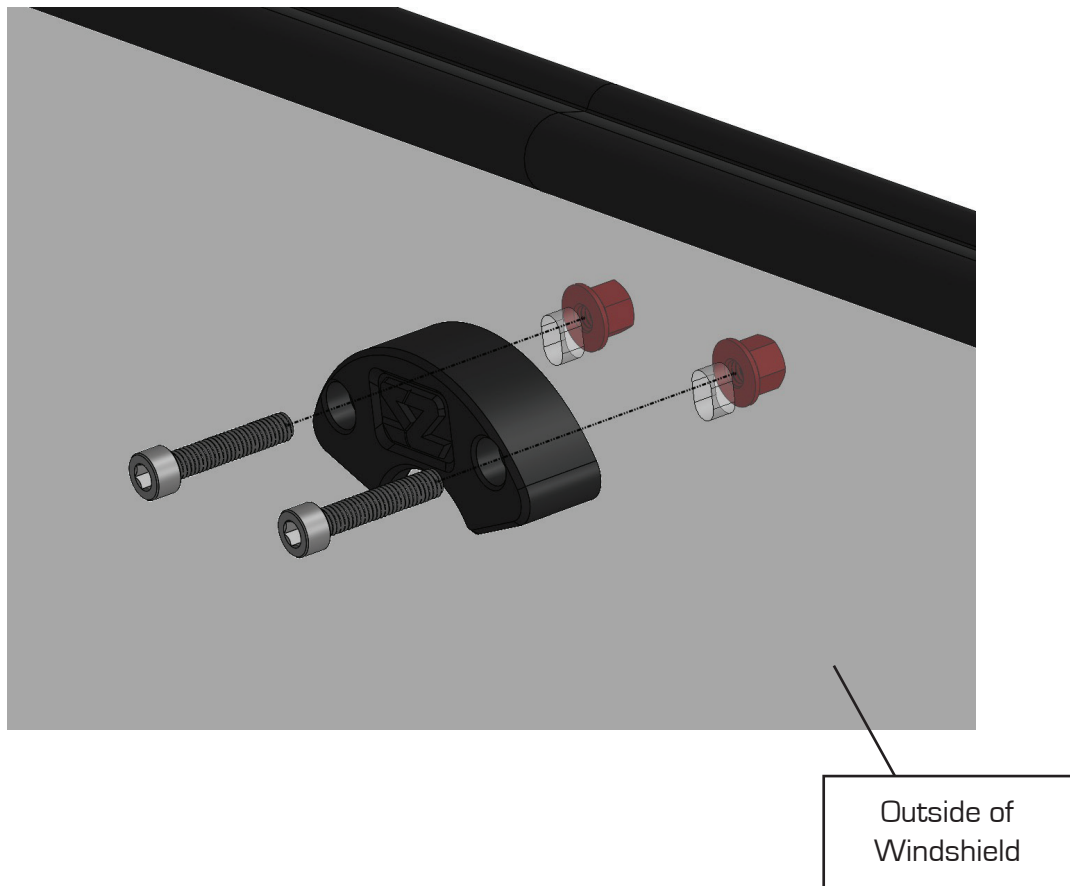

STEP 5

- Make sure to lift any protective film out of the way during installation and consider using some quick-grip clamps if installing by yourself, or have someone help hold it in place for the installation process.
- Fit the pro-fit clamps (Item D) onto the vehicle structure with the SZ logo facing out.
- Place the windshield on the vehicle with the levers toward the interior of the vehicle.
- Line up the slots on the windshield panel and the pro-fit clamp and secure it in place by tightening the nut.



STEP 6

After both pro-fit clamps are tightened and the windshield secured, it should look something like this. Make sure to rotate the levers on the inside to latch onto the vehicle frame before taking off the quick-grip clamps so the windshield doesn't down.

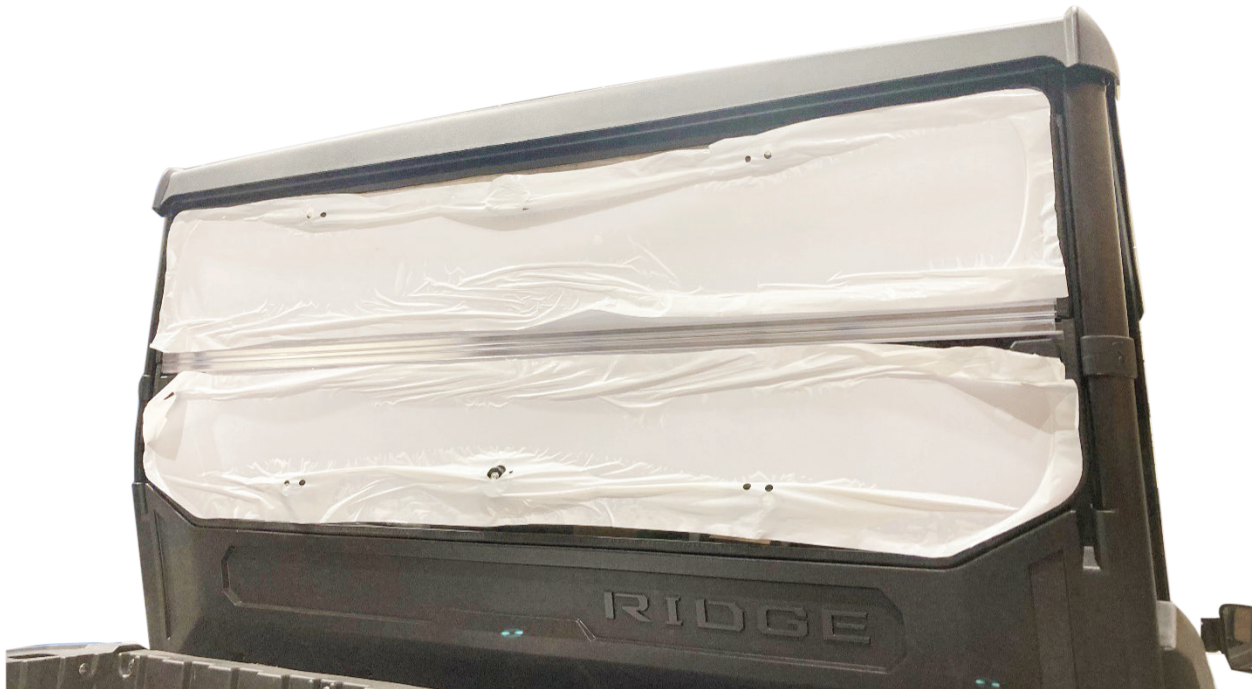

Inside: Levers are rotated securely.

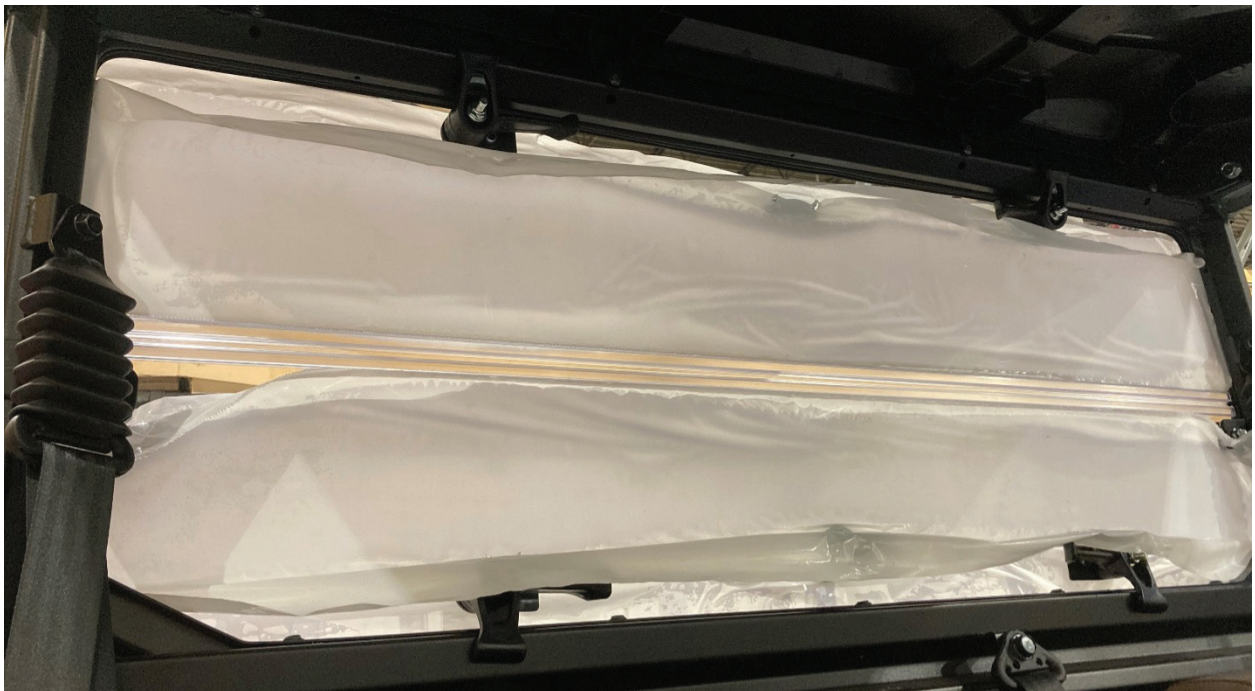

After securing everything down, you can now remove the protective film on all sides of the windshield panels, and your product is ready for use!



INSTALLATION COMPLETE